

INSTRUCTION SHEET HAND PLIERS PRP26A

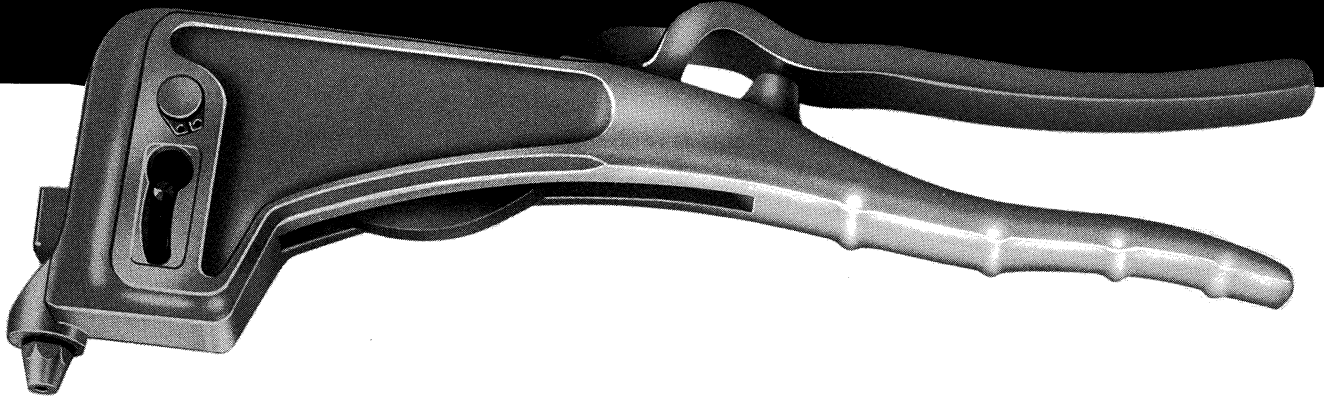

OPERATING INSTRUCTIONS

- 1) Open Handles completely. Insert rivet mandrel into Nosepiece until Rivet head is in contact with face of Nosepiece.
- 2) Close Handles lightly until contact is made between Rivet mandrel and Plier Jaw. At this point using Plier as a guide, insert Rivet into hole of unit to be riveted.
- 3) Note bottom face of Rivet head and outer surface of unit to be riveted **MUST** be in contact at this time.
- 4) Squeeze Handles until Rivet is set.
- 5) Open Handles to their extremes and expendable Rivet mandrel will be free to remove.
- 6) If two strokes are necessary to set the Rivet, the upper Handle must be reopened completely, and the Plier slipped down so that the Nosepiece is again in contact with the head of the Rivet.
- 7) Now squeeze Handles again and Rivet should set.

TO CHANGE COLLET JAW

- 1) Remove Fulcrum Pin Retainer PRG402-100 in Body Casting by prying off with screwdriver, and push out Fulcrum Pin 40.
- 2) Push Lever 24A upwards to tilt the Collet Case PRP25A.
- 3) Centralize the Guide Pin 20 with the enlarged portion of the guide slot in the Body Casting and punch out the Guide Pin 20.
- 4) Expose the Collet Case PRP25A by pushing Lever 24A fully upwards and to the front and punch out the Link Pin 14 to disconnect Collet Case PRP25A from Lever 24A and remove Collet Spring Screw PRP100 and Collet Spring 10 and slide out the Collet Jaw 11A or 12A or 27.

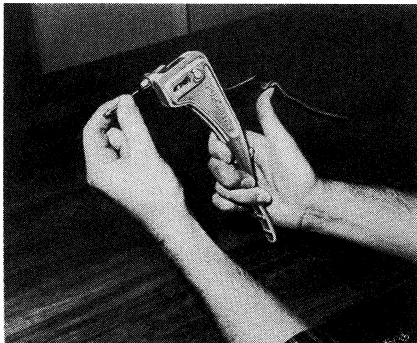

Place mandrel of Rivet in Nosepiece of tool with Handles open.



Insert Rivet in predrilled hole and squeeze Handles until mandrel breaks.

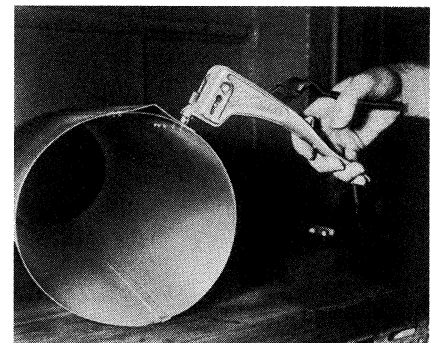

Result ... a permanent, vibration proof assembly – Rivet is installed and set from the same side.

TO REASSEMBLE

Reverse the procedure set out above. In replacing the Guide Pin 20 ensure that the Shoulders of this Pin are flush with the surface of the

Collet Case PRP25A. Engage the Guide Pin 20 in the Guide Slot (This should slide easily). Align the holes for the Fulcrum Pin 40.

FOR USE WITH THE FOLLOWING "POP" RIVETS

RIVET	MANDREL	3/32	7/64	1/8	5/32
OPEN END RIVETS					
aluminum	aluminum	●		●	●
aluminum	steel	●		●	
steel	steel	●		●	
monel	steel		●	●	
stainless	steel			●	
stainless	stainless			●	
CLOSED END RIVETS					
aluminum	aluminum			●	●
aluminum	steel			●	

LUBRICATION GUIDE

Grease Guide Slots
Oil Sides of Jaw
Oil Pins and Pin Holes

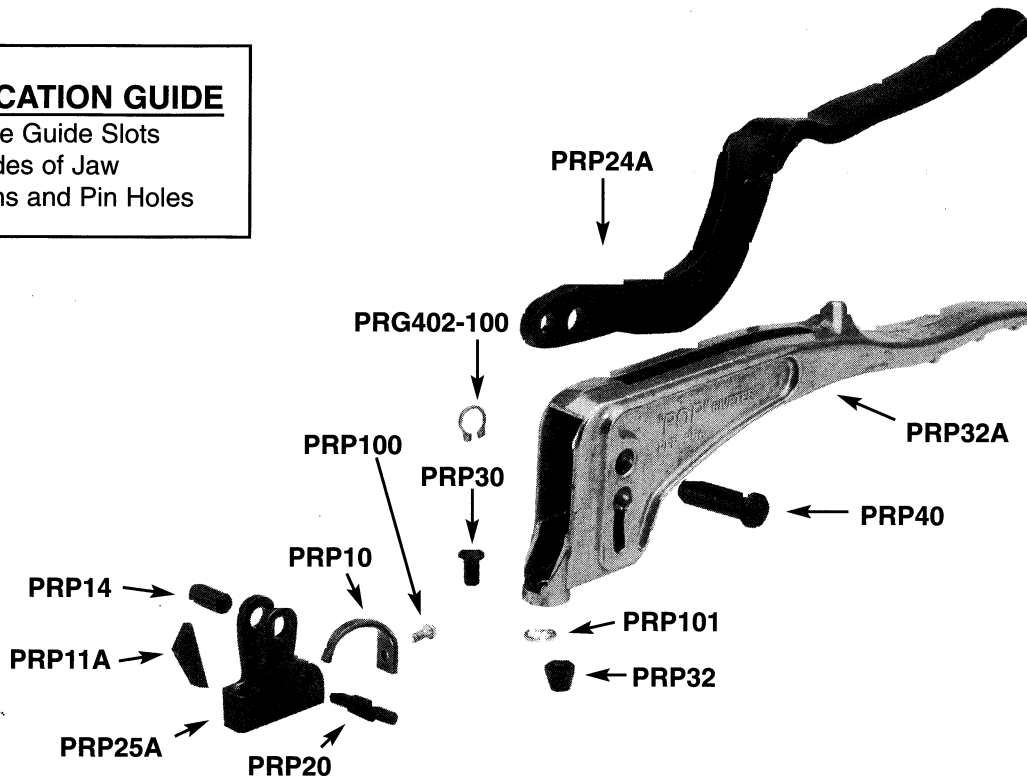

PARTS LIST FOR PLIERS PRP26A

PARTS NO.	DESCRIPTION	QUANTITY
PRG402-100	Fulcrum Pin Retainer	1
PRP10	Collet Spring	1
‡PRP11A	Jaw (Type "C" for 1/8" Dia. Open End "Pop" Rivets)	1
*PRP12A	Jaw (Type "D" for 5/32" Dia. Open End "Pop" Rivets)	1
PRP14	Link Pin (For Securing 25A to 24A)	1
PRP20	Guide Pin	1
PRP23A	Support	1
PRP24A	Lever	1
PRP25A	Collet Case	1
*PRP27	Jaw (Type "B" for 1/8" Dia. Closed End "Pop" Rivets and 3/32" Dia. Open End "Pop" Rivets)	1
PRP30	Jaw Pusher	1
*PRP31	Nosepiece Nut (For 3/32" Dia. Open End "Pop" Rivets)	1
‡PRP32	Nosepiece Nut (For 1/8" Dia. Open End "Pop" Rivets)	1
‡*PRP33A	Nosepiece Nut (For 5/32" Dia. Open End "Pop" Rivets)	1
*PRP39	Nosepiece Nut (For 1/8" Dia. Closed End "Pop" Rivets)	1
PRP40	Fulcrum Pin	1
PRP100	Collet Spring Screw (Rd. Hd. Mach. No. 4-40NC x 1/4")	1
PRP101	Jaw Pusher Washer	1

*Not Regular Equipment. Must be ordered separately.

‡Also used with Closed End Aluminum Rivets with Aluminum Mandrels only.

See Chart on Front Page

Emhart Fastening Technologies

Industrial Division

510 River Road, P.O. Box 859
Shelton, CT 06484
Tel. (203) 924-9341
Fax (203) 925-3109

California Office & Warehouse

1402 McGraw
Irvine, CA 92614
Tel. (949) 851-2298
Fax (949) 851-2099

Canadian Office & Warehouse

3545 Thimons Boulevard
St. Laurent, Quebec, H4R 1V5
Tel. (514) 333-8080
Fax (514) 338-3829



PRINTED IN U.S.A.

© Reg. U.S. Pat. Off.

Visit our Website @ www.emhart.com

A BLACK & DECKER COMPANY