

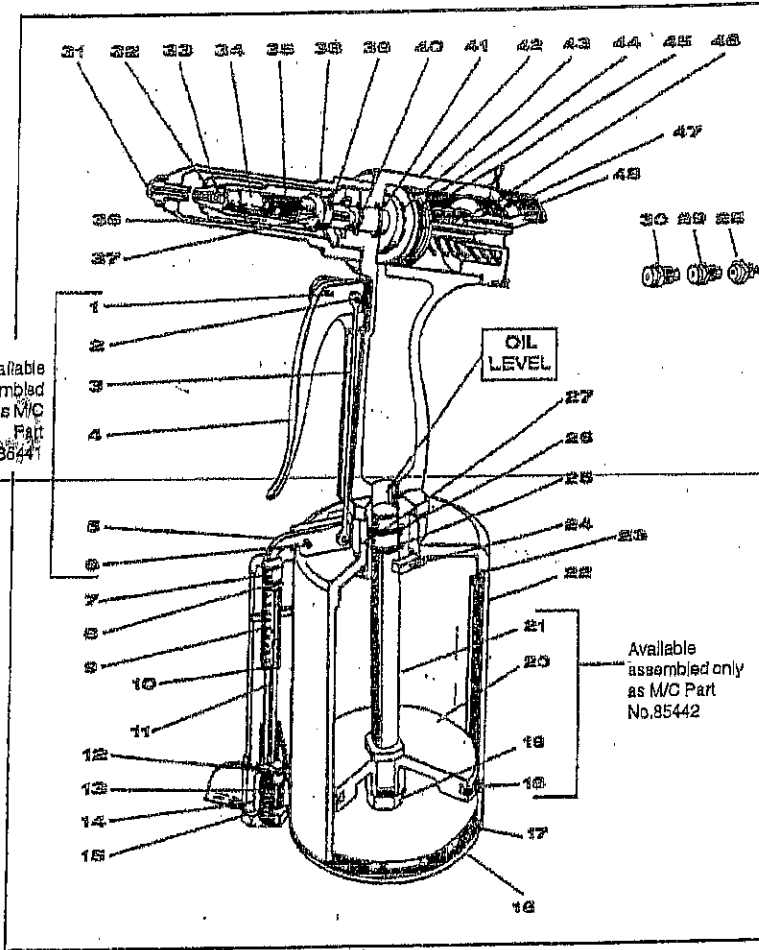

CREATIVE FASTENER INC.
INSTRUCTIONS AND PARTS LIST
FOR 39050 (300) & 39051 (300-E)



SCHMATIC PART NO.	M/C PART NO.	DESCRIPTION
1.*	85188	Trigger Setting Pin
2.*	85401	Connector Pins (2)
3.*	85202	Trigger Rod
4.*	85403	Trigger Handle
5.*	85404	Trigger Lever
6.*	85328	Trigger Lever Setting Pin
7.	85408	Valve Pusher
8.	85407	Valve Pusher O-Ring (top)
9.	85408	Valve Spring (top)
10.	85409	Valve Pusher Coiler
11.	85410	Valve Pusher O-Ring (bottom)
12.	85323	Valve
13.	85324	Valve Spring (bottom)
14.	85413	Plug
15.	85337	Plug O-Ring
16.	85415	Cylinder Cap
17.	85416	Cylinder Cap O-Ring
18.**	85417	Air Piston O-Ring
19.**	85418	Air Piston Locknut
20.**	85419	Air Piston
21.**	85420	Air Piston Rod
22.	85421	Cylinder
23.	85422	Air Piston Stop
24.	85318	Frame Lock Nut
25 & 26.	85330	Air Piston Frame O-Ring (outer & inner)
27.	85326	Frame Setting Pin
28.	85375	1/8" Nosepiece
29.	85376	1/8" Nosepiece
30.	85377	1/8" Nosepiece
31.	85378	1/8" Nosepiece
32.	85349	Jaw Case (front)
33.	85387	Gripper Jaws (3-piece set)
34.	85383	Jaw Piston
35.	85384	Piston Spring
36.	85382	Jaw Case (rear)
38.	85385	Frame Head
39.	85388	Jaw Case Locknut
40 & 41.	85330	Oil Piston Frame O-Ring (outer & inner)
42.	85308	Frame
43.	85317	Oil Piston
44.	85329	Oil Piston O-Ring
45.	85340	Oil Piston Backup O-Ring
46.	85319	Return Spring
47.	85335	Frame Cap O-Ring
48.	85318	Frame Cap
49.	85441	Trigger Assembly
50.	85442	Air Piston Assembly
51.	85447	O-Ring Replacement Kit

Available assembled only as M/C Part No. 85441

Available assembled only as M/C Part No. 85442

ADDITIONAL PARTS FOR 39051 ONLY

SCHMATIC PART NO.	M/C PART NO.	DESCRIPTION
Not Shown	85349E	Drilled Front Jaw Case
Not Shown	85383E	Jaw Piston
Not Shown	85385E	Frame Head
Not Shown	85390E	Elbow
Not Shown	85391E	Quick Disconnect
Not Shown	85392E	Valve
Not Shown	85393E	Frame Cap
Not Shown	85394E	Tubing
Not Shown	85354E	Container
Not Shown	85421E	Cylinder

CAUTION: Always wear safety goggles when using this tool.

SPECIFICATIONS

Capacity	3/32", 1/8", 5/32", 3/16"
Air Pressure:	85-95 PSI
Average Air Consumption	4 CFM
Air Inlet	1/4" NPT
Hose Size	3/8" ID
Weight;	3.4 lbs.

* Sold only as 85441; ** Sold only as 85442